



DUO BEAM LED CEILING TILE TROFFER

Project: _____

Date: _____

Comments: _____

Performance & Specifications

Color Temperature 4000K
CRI 84 min
Input Voltage 102-277, 347 & 480 VAC
Warranty 10 Years
Projected L70* min 200,000 hrs
Dimming 0-10 Volts

*L70 TM-21 projection calculated at 25 °C.

Frame	Height (in.)	Input Power (W)	Max Lumens (nominal)	Efficacy
1x4	1.75	28	3300	125
		20	2200	110
2x2		29	3300	118
		20	2200	112
2x4		38	5000	128
		33	4000	123
	28	3300	125	

Additional Ordering Options

- Integrated Occupancy and Daylight & Harvesting Sensor - Field Programmable
- Battery backup
- Air Handling

Product Benefits

- The fastest return on investment available for a complete fixture troffer.
 - Leading system efficacy.
- Zero maintenance.
- Architectural grade finish.
- Fluorescent equivalent image quality.
- Developed & patented in the USA. Manufactured & assembled in the USA of U.S. and imported parts.
- Custom sizes & finishes available.

Measurements

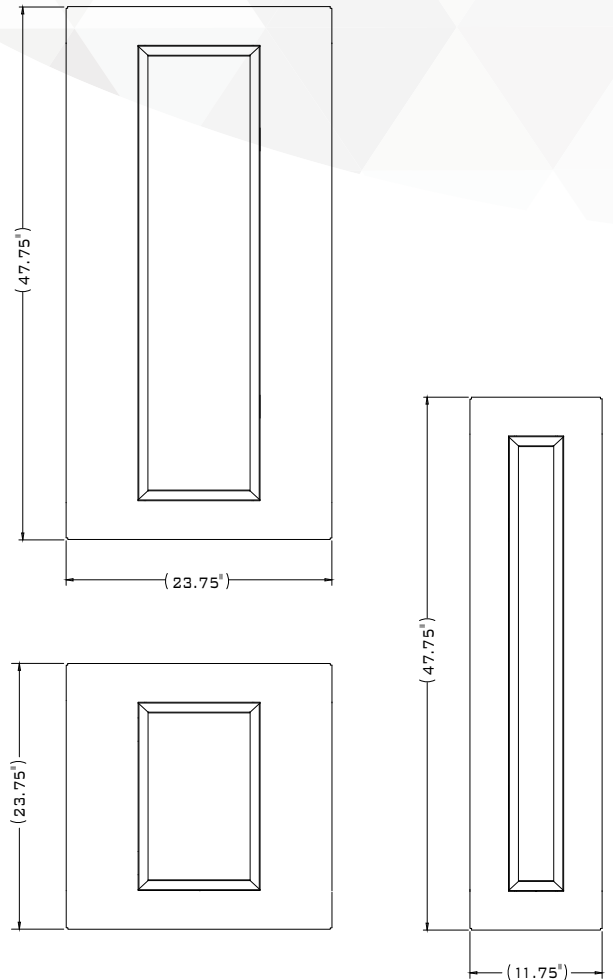

Qualifications





2x4-4000L-40K Photometric Details (representative)

Intensity Summary (cd)

Gamma	C-Plane					Flux (lm)
	C0	C22.5	C45	C67.5	C90	
0.0	1611	1611	1611	1611	1611	
5.0	1599	1599	1599	1602	1601	152
10.0	1569	1569	1569	1572	1571	
15.0	1520	1520	1521	1524	1523	429
20.0	1453	1453	1455	1459	1458	
25.0	1371	1371	1374	1378	1377	632
30.0	1275	1276	1279	1284	1284	
35.0	1169	1171	1175	1180	1181	735
40.0	1056	1058	1063	1069	1069	
45.0	939	941	946	952	953	730
50.0	819	821	826	832	833	
55.0	698	700	706	711	713	631
60.0	578	581	585	590	592	
65.0	460	462	466	470	471	461
70.0	343	344	348	351	352	
75.0	230	231	233	236	236	247
80.0	125	125	127	129	129	
85.0	40	40	41	42	41	53
90.0	0	0	0	0	0	

Two Plane Symmetry

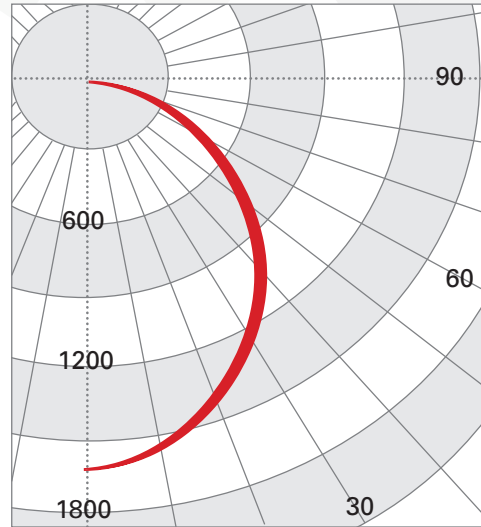

Zonal Flux and Percentages

Zone	Flux (lm)	% Lamp	% Luminaire
0-30	1213	N/A	29.8
0-40	1948	N/A	47.9
0-60	3308	N/A	81.3
0-90	4069	N/A	100.0
40-90	2121	N/A	52.1
60-90	761	N/A	18.7
90-180	0	N/A	0.0
0-180	4069	N/A	100.0

Average Luminance (cd/sq.m)

Gamma	C0	C45	C90
45	5384	5481	5565
55	4062	5162	5252
65	4610	4710	4795
75	3797	3888	3957
85	1905	2033	2064

Coefficients of Utilization - Zonal Cavity Method Effective Floor Cavity Reflectance 0.20

RC	80					70				50			30			10			0
	70	50	30	10	70	50	30	10	50	30	10	50	30	10	50	30	10	0	0
0	119	119	119	119	116	116	116	116	111	111	111	106	106	106	102	102	102	100	
1	109	105	101	97	107	102	99	95	98	95	92	94	92	89	91	89	87	85	
2	100	92	85	80	97	90	84	79	86	81	77	83	79	75	80	76	73	71	
3	91	81	73	67	89	79	72	66	76	70	65	74	68	64	71	66	63	60	
4	84	72	63	57	81	71	63	56	68	61	56	66	60	55	64	58	54	52	
5	77	64	56	49	75	63	55	49	61	54	48	59	53	48	57	52	47	45	
6	71	58	49	43	69	57	49	43	55	48	42	54	47	42	52	46	42	40	
7	66	53	44	38	64	52	44	38	50	43	38	49	42	37	48	42	37	35	
8	62	48	40	34	60	48	40	34	46	39	34	45	38	34	44	38	33	32	
9	58	44	36	31	56	44	36	31	43	36	31	42	35	30	41	35	30	28	
10	54	41	33	28	53	40	33	28	40	33	28	39	32	28	38	32	28	26	



DUO BEAM LED CEILING TILE TROFFER

MODERN APPEARANCE: The Duo Beam LED Ceiling Tile Troffer series provides a fresh and refined look compared to older parabolic louver and prismatic lens fixtures.

AIR HANDLING FIXTURES: An optional frame configuration is available for existing fixtures that return air to the HVAC system.



EnviroLux® can configure products to fit your customer's specific needs. Contact us for more details!



STANDARD



AIR HANDLING

Model	Product Size	Wattage	Color Temp.	Battery & Transformers	Sensory Option
ENV-DUO-TROFFER	1x4	28W 20W	40K-4000K	N -None (standard) B -Emergency Battery Pack 3 -347 V 4 -480 V PW -6' Power Whip	N -None SE -Occupancy only SED1 -Daylight harvesting & occupancy
	2x2	29W 20W			
	2x4	38W 33W 28W			
Order Form					Qty
	__ x __	__ W*	__ K	-	-
		__ W*	__ K	-	-
		__ W*	__ K	-	-

*Write-in custom wattage value if required, must be less than max wattage /size

Example Order: ENV-DUO-TROFFER-2x4-28W-40K-N-N