

EnviroLux Led High Lumen 60 Watt Easy Hang linear Highbay



| | |
|----------------------------|---------------|
| Project Information | |
| Project Name: | Fixture Type: |
| Complete Catalog #: | Date: |
| Comments: | |

The EnviroLux LED Easy Hang Linear High Bay product line is available in several wattages with a wide choice of mounting configurations and optical distributions designed to replace HID lighting systems from 100w to 400w MH or HPS. Typical commercial high bay lighting applications include commercial warehouse facilities, and manufacturing facilities where our up to 201 Lumens Per Watt and high CRI of 80 Efficiency, help factory workers best disseminate their production equipment and surroundings for safety. Fixture wattages for mounting heights of up to 100 feet are available.

Specifications and Features:

Housing:

Single Piece Co-Extruded Lens and Housing. (f1) Rated Acrylic or Polycarbonate. Vented End plugs. Liquid Silicon Rubber gaskets adhered to the end caps. Acme screws on both ends to hold the entire unit together. The locknut wall to ease tightening of the cord grip used for the power input feed. Easy Daisy Chain capability.

Listing & Ratings:

CSA: Listed for Dry Locations, ANSI/UL 1598, 8750; IP65, 66.

Finish:

Black and Frosted Polycarbonate

Mounting Options:

Mount with Included V-Hangers. Includes a 3' 3-Wire Cord with Leads.

LED:

Aluminum Metal Core - 2oz Copper Inlay

Wattage:
60 Watt



Driver:

Electronic Driver, 120-277V, 50/60Hz; Less Than 20% THD and PF>0.90. Standard Internal Surge Protection 6kV. 0-10V Dimming Standard for a Dimming Range of 100% to 10%; Dimming Source Current is 150 Microamps.

Controls:

Fixtures Ordered with Factory-Installed Photocell or Motion Sensor Controls are Internally Wired for Switching and/or 1-10V Dimming Within the Housing. Remote Direct Wired Interface of 1-10V Dimming is Not Implied and May Not Be Available, Please Consult Factory. Fixtures are Tested with EnviroLux Controls and May Not Function Properly With Controls Supplied By Others. Fixtures are NOT Designed for Use with Line Voltage Dimmers.

Warranty:

7-Year Warranty for -40°C to +50°C Environment.

See Page 2 for Projected Lumen Maintenance Table

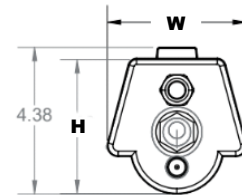
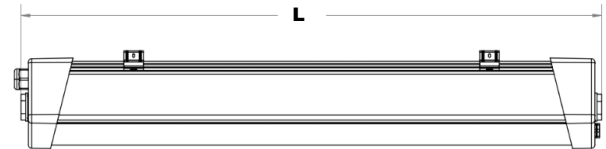

| Dimensions | | Widths (C) | |
|------------|-------|------------|-------|
| Height (A) | 3.75" | 60w | 3.86" |
| Length (D) | 46" | | |

Complete Units
Ordering Information
Example: EES-EH-4FT-60W-LED-LHB-PS-UNV-XXXX

EnviroLux High Lumen 60 Watt Industrial Easy Hang Linear High Bay

| Model | Wattage | Driver | CCT | Color | Options |
|---|------------------|---------------------|----------|---------|---------|
| EES-EH = Easy Hang Linear LED Highbay | 60W-LED = 60w | UNV-PS= 120-277V | 5K=5000K | W=White | |

NEMA 4X

IP65

IP66

RoHS

PS1500

SF=Single Fuse*
DF=Double Fuse*
SP=Surge Protection
M3=Microwave Sensor for Mounting Heights of 20 Feet or Above.*
CP6120W=6' White Cord, 3 Wire, L5-15P Twist-Lock Plug
CP6277W=6' White Cord, 3 Wire, L7-15P Twist-Lock Plug
C6600B=6' Black Cord, STW, 600VAC, 3 Wire, Leads
C6600W=6' White Cord, STW, 600VAC, 3 Wire, Leads
C4600B=4' Black Cord, SEOWW, 600VAC, 3 Wire, Leads
EMB=Battery Backup, 90 Minutes*
EW=EnviroLux Wireless
GR=Gripple (Pair 10ft)



Scan to watch our Made in USA video



EnviroLux Led High Lumen Industrial Easy Hang linear Highbay



Photometric Performance

| LED Watts | Drive Current (mA) | Input Watts | Optics | Spacing Criteria | 5000 CCT 80 CRI | |
|-----------|--------------------|-------------|-------------|------------------|-----------------|-----|
| | | | | | Lumens | LPW |
| LED 60w | 2200 | 60 | Wide (100°) | 1.16 | 10.854 | 201 |

Lumen Maintenance

| Data shown for 5000 CCT TM-21-11 | Input Watts | Compare to MH | | | | Calculated LED Life |
|--------------------------------------|---------------------------------------|---------------|------------|------------|-------------|---------------------|
| | | Initial | 25,000 Hrs | 50,000 Hrs | 100,000 Hrs | |
| L70 Lumen Maintenance @ 25°C / 77°F | All wattages up to and including 180w | 1.00 | 0.89 | 0.79 | 0.58 | 100,000 |
| L70 Lumen Maintenance @ 50°C / 122°F | | 1.00 | 0.86 | 0.72 | 0.44 | 54,000 |
| L80 Lumen Maintenance @ 40°C / 104°F | | 1.00 | 0.87 | 0.74 | 0.47 | 70,000 |

NOTES:

1. Projected per IESNA TM-21-11. Data references the extrapolated performance projections for the 525mA base model in a 25°C ambient, based on 10,000 hours of LED testing per IESNA LM-80-08.
2. Compare to MH box indicates suggested Light Loss Factor (LLF) to be used when comparing to Metal Halide (MH) systems.

Photometric Data

